

MOTOR HAS BEEN HIDDEN TO SHOW MOUNTING HOLES

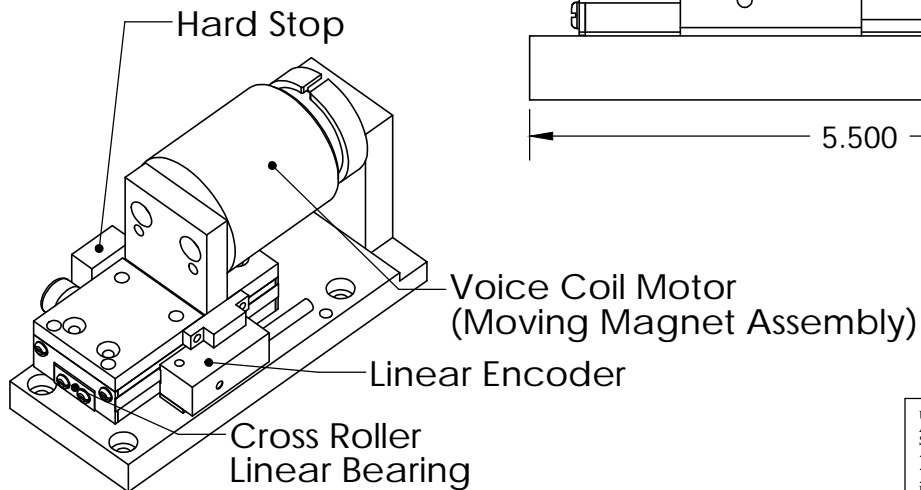
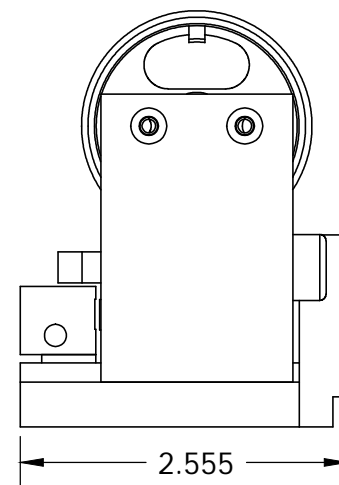
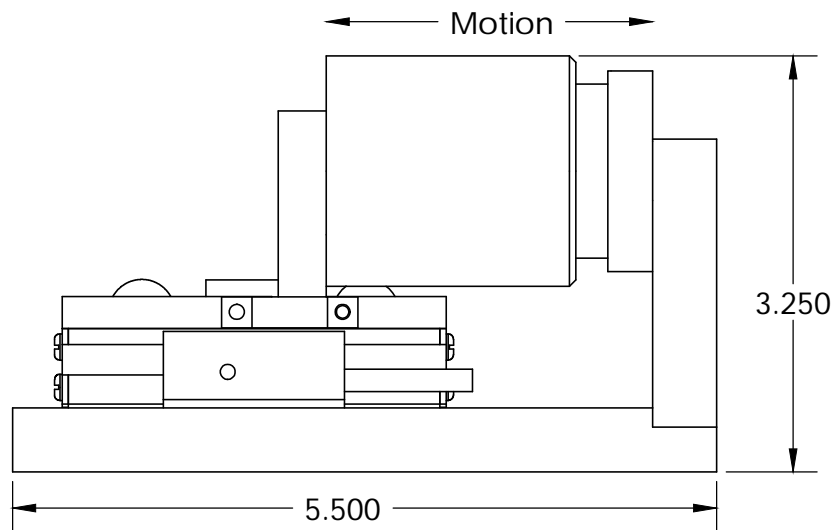
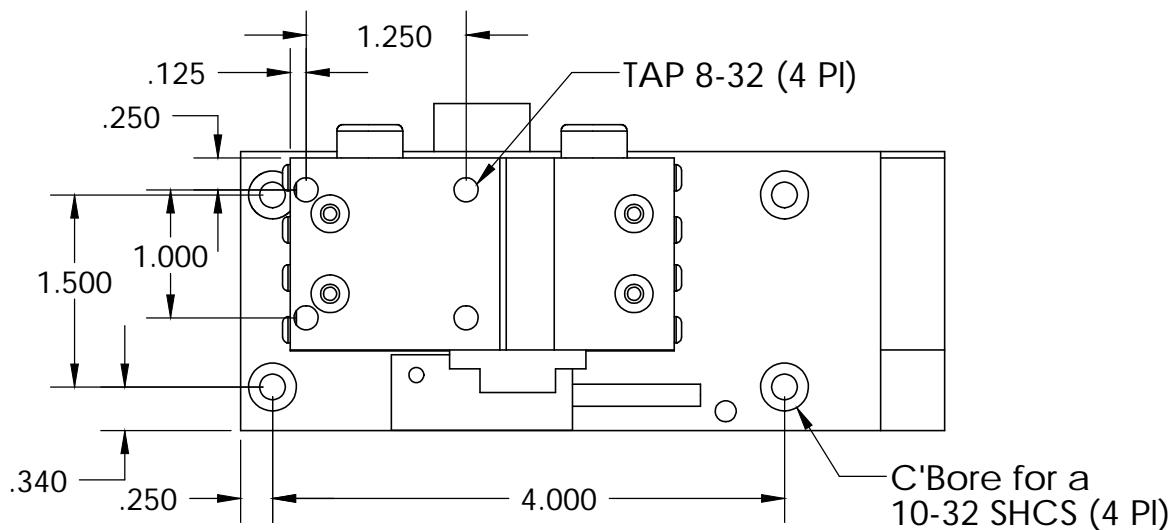

UNLESS SPECIFIED OTHERWISE:
All dimensions are in inches
Standard Tolerances are as follows:
.XXX ±.005 ANGLES ±1°
.XX ±.010 FILLETS .010
.X ±.020 CORNERS .010
Remove All Burrs and Sharp Edges

MATERIAL			
FINISH			
DRAWN OOG	DATE 8-20-08	APPROVED MPW	DATE 8-20-08

TITLE			
H2W Technologies, Inc. 26470 Ruether Ave #102 Santa Clarita, CA 91350 USA Tel: (661) 251-2081 Fax: (661) 251-2067 www.h2wtech.com			
Voice Coil Positioning Stage Model #: VCS05-060-CR-001			
DWG # 31-0088	REV ---	SHEET 1 of 2	

MOVING COIL NON-COMM ACTUATOR SPECIFICATIONS		
Motor P/N	NCC05-18-060-2X	
Stroke	0.50"	12.7 mm
Encoder Resolution	0.1 micron	
Bearing Type	Crossed Roller	
Moving Mass	1.14 lbs	518 grams
Total Mass	2.23 lbs	1012 grams
Resistance @ 20C	11.5 ohms	
Inductance @ 20C	4.5 mH	
Electrical Time Constant	0.39 msec	
Motor Constant	1.78 LBS/SQRT(Watt)	7.92 N/SQRT(Watt)
Force Constant	6.3 LBS/Amp	27.8 N/Amp
Back EMF	0.7 V/ips	27.8 V/m/sec
Continuous Force	6.0 LBS	26.7 N
Max Power @ 100% Duty	12 Watts	
Peak Force	18.0 LBS	80.1 N
Max Power @ 10% Duty	102 Watts	

TITLE Voice Coil Positioning Stage Model #: VCS05-060-CR-001		
DWG # 31-0088	REV ---	SHEET 2 of 2